

A New Training, Conference and Information Facility for CIMMYT

International Maize and Wheat Improvement Center

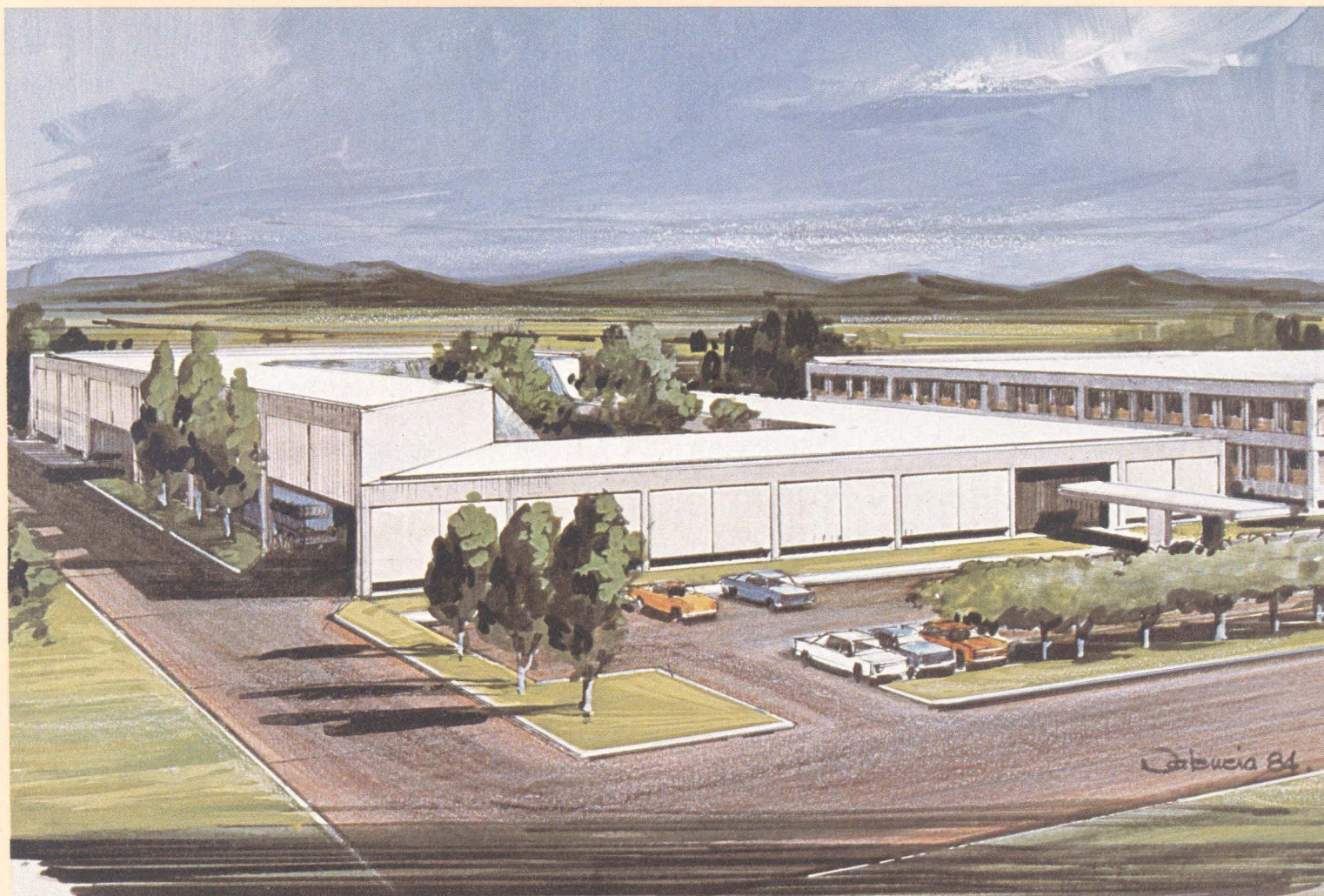

The Need

Maize and wheat researchers throughout the developing world look to CIMMYT as their international research center of excellence on these crops. The growing requirements of developing country research institutions in germplasm development, training and information exchange will demand that CIMMYT make important changes in its program activities in the years ahead.

In 1971, CIMMYT inaugurated its existing headquarters physical plant in the midst of a considerable expansion in the Center's relationships with agricultural research and production institutions in the Third World. With world acclaim for its "Green Revolution" semidwarf wheat varieties (1970 Nobel Peace Prize for Norman E. Borlaug; 1970 UNESCO Science Prize shared with IRRI), CIMMYT was catapulted during the ensuing decade into a much broader research, training and information role within the global agricultural research community. The demand for these services has never been greater.

Today, CIMMYT works with agricultural researchers in more than 125 countries. The Center ships over two million packets of experimental seed annually to cooperators around the world. More than 2,500 agricultural scientists in 90 countries are alumni of CIMMYT's in-service training and visiting scientist programs (see Figures 1 and 2). CIMMYT relies on continuing dialog and feedback from these various clientele to ensure relevance in its research, training and information dissemination activities.

While the size of CIMMYT's international maize and wheat research network has increased dramatically over the past decade, so too has the fundamental nature of the Center's relationship with national research institutions and individuals that make up this network. At the beginning of the 1970s, many of these institutions were just initiating their maize and wheat research programs. Today, a number of these programs are staffed with highly competent maize and wheat researchers. The more advanced national programs, however, now seek to improve the professional scope and depth of their senior scientists. At the same time, the less advanced programs (in some cases, only recently established) still require practical, in-service training for their most promising young scientists in the basics of crop research.

CIMMYT believes it is essential to maintain the current level of in-service training at headquarters in Mexico while expanding substantially the number of longer-term visiting scientist fellowships it offers annually. Fellowships are intended primarily for national program collaborators, former trainees, and associate scientists on sabbatical leave—all partners in a vital and unique global network of agricultural researchers committed to raising the quantity and quality of food available in the developing world.

Training activities outside Mexico are also being considerably increased through the efforts of CIMMYT's regionally posted scientific staff. The expansions in regional and in-country training activities require increasing back-up support services in Mexico. Staff and facilities are needed to prepare training-related materials (manuals, field guides and audio-visuals) for use by regional staff in these training courses.

CIMMYT is also committed to facilitating the exchange of scientific information related to maize and wheat research among network collaborators. National crop research programs seek increased access to the scientific data and information generated by the agricultural scientific community at large. CIMMYT's growing activities in this regard include a new bibliographic and documentation service, an expanded program of conferences and workshops, and an increasing number of publications designed to support and complement the maize and wheat research efforts of collaborating national programs throughout the developing world.

Additional classrooms are needed to attend to CIMMYT's eight different technical in-service training courses. Office space for visiting scientists is also limited, as is the Center's technical library to support their research activities. The facilities for preparing training materials are currently stretched beyond their intended capacity, and the meeting rooms used for hosting conferences and workshops are poorly designed for this purpose and are insufficient in number to accommodate an expanded agenda.

In 1980, a new 16-room visiting scientist dormitory was constructed using funds from the Federal Republic of Germany. When this space is coupled with our existing apartment complex and guest house, CIMMYT has sufficient accommodations to permit, with appropriate scheduling of events, a significant increase both in visiting scientist fellowships and in the number of conferences and workshops hosted each year.

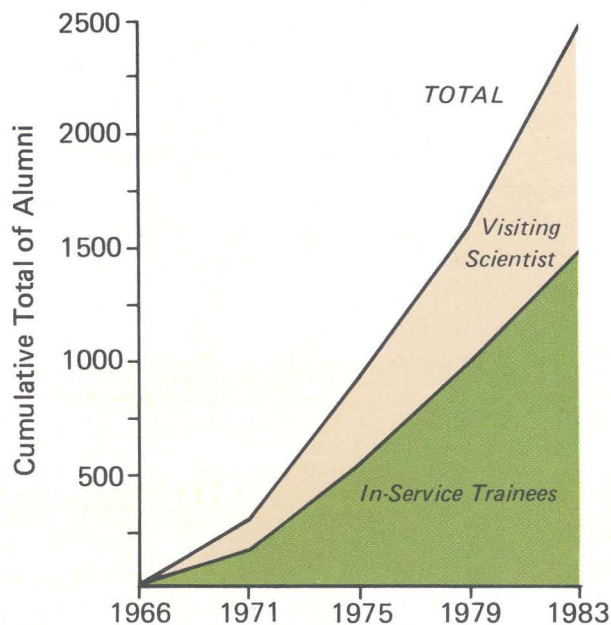

In-Service Trainees and Visiting Scientists

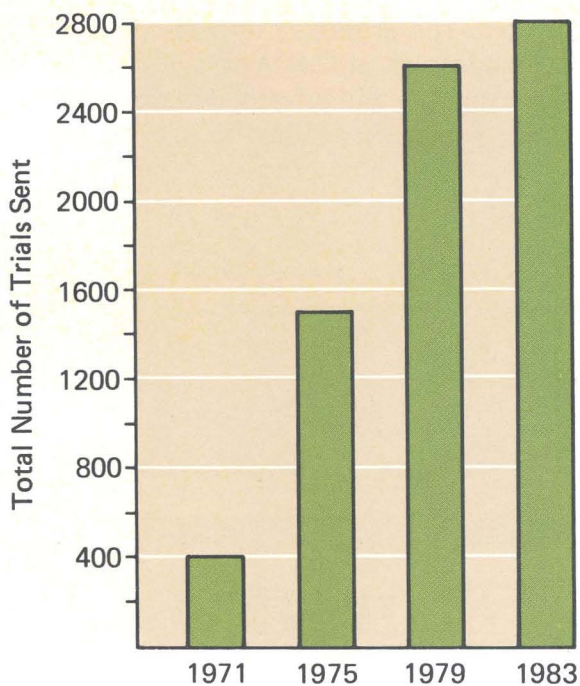

International Maize and Small Grains Testing Programs

The Proposal

CIMMYT has developed a preliminary design for a new training, conference and information services facility to be located at its headquarters. The new facility is intended to meet the growing needs and expectations of developing country clientele in the 1980s and beyond. The facility should greatly increase CIMMYT's capacity as the institutional hub for the international maize and wheat research networks so crucial to meeting world food production needs.

The proposed site for this new 4500 square meter structure is located immediately adjacent (to the west) to CIMMYT's existing administrative building, which houses the offices of most of our headquarters-based senior scientific staff. The new facility maintains a similar design to the administrative building, making it possible to physically link the two structures. The proposed new building can accommodate all of CIMMYT's current and planned training and information staff and activities for the foreseeable future.

CIMMYT would like to commence construction of this new addition to its headquarters facility in early 1985 so that it might be inaugurated during the 1986 calendar year. While actual dollar costs will depend on a variety of factors, it is estimated that the building can be constructed at a very moderate cost per square meter. In addition, the proposed design will permit lower maintenance costs as compared to CIMMYT's older structures.

The estimated costs are as follows:

Total building cost US\$ 1,250,000
4500 square meter building structure
(including all utilities and special
communication and power installations)

Equipment US\$ 225,000
Includes supplementary furnishings and
equipment

Contingency US\$ 125,000
A 10 percent contingency is included to
cover unforeseen cost overruns and
increases

Grand Total US\$ 1,600,000

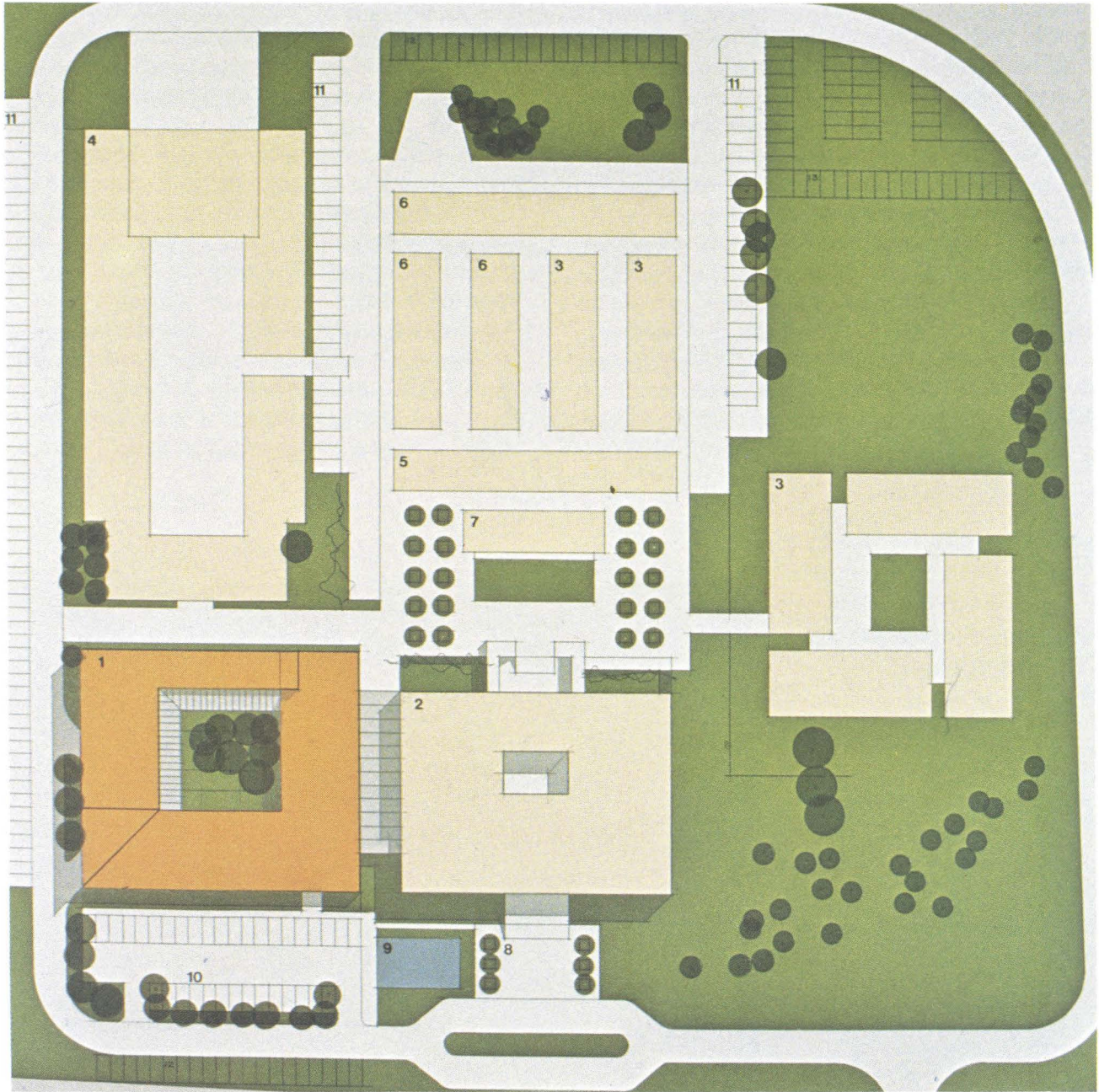

- | | | | |
|----|--|-----|-----------------------|
| 1. | New building: training, conference and information services facility | 6. | Greenhouses/headhouse |
| 2. | Administrative building | 7. | Power house |
| 3. | Laboratories | 8. | Main access |
| 4. | Seedhouse/Germplasm Bank | 9. | Fountain |
| 5. | Data Processing building | 10. | Existing Parking |
| | | 11. | Proposed Parking |

CIMMYT

Centro Internacional de Mejoramiento de Maíz y Trigo
El Batán, Texcoco, México

Nuevo Edificio:
Training, Conference and Information Services Facility

Planta de Conjunto

Escala 1:500



Augusto H Alvarez Arquitecto y Asociados SC
Mayo de 1984

The Design

A multi-purpose training and conference center will occupy the main floor level of the new building. Three large classrooms are planned, each with a capacity of 40 people; two smaller classrooms for 20 people each are also included (with a removable center wall to permit the accommodation of up to 40 people at one time). A micro computer classroom (with eight work stations) is planned to provide for training in the use of analytical computer programs. Office and secretarial space has also been allocated to support up to 10 full-time training officers, allowing CIMMYT to house its maize, wheat, economics and experiment stations training

staff in one unified space. A third floor (not shown below) will be partially developed to provide offices for visiting scientists, and for associate scientists on sabbatical leave.

A conference area with multiple seminar rooms is also planned. The principal seminar room would have a maximum capacity of 100 people and would have removable partitions, as well as a simultaneous translation and A/V projection booth. The two smaller classrooms mentioned previously are adjacent to the main seminar room's simultaneous translation and A/V projection booth so that this facility can be used for both training and conference purposes.

Training Offices and Facilities

- 1.a international staff offices
- 1.b secretarial space
- 1.c classroom space
 - 1.c.1 classroom (40 people)
 - 1.c.2 classroom (20 people)
 - 1.c.3 projection & translation booth
- 1.d microcomputer workroom

Conference Facility Area

- 2.a seminar room (100 people)
- 2.b foyer, seminar expansion area
- 2.c projection & translation booth

Services

(Air Conditioning, Sanitary, etc.)

- C. hallways
- E. elevator

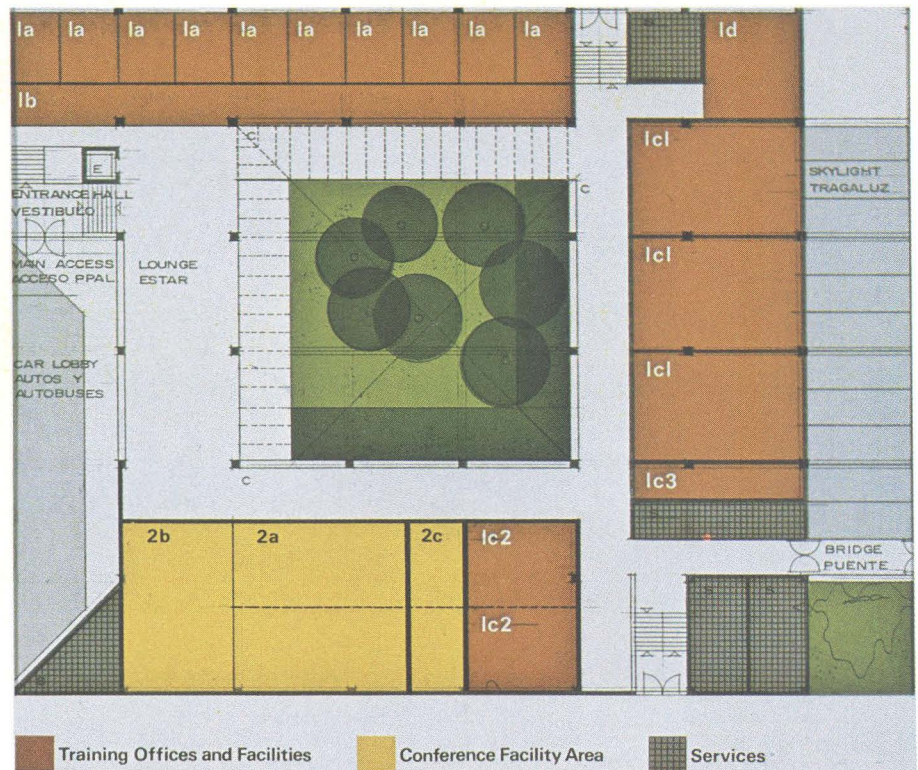

Main Floor Level

In Summary

The library, scientific information unit and the communications department will occupy the basement floor level. The proposed facilities include 200 square meters for library stacks, a 40-person capacity reading room/study area, a microfilm/microfiche and computer terminal, users' area, a scientific bibliography and documentation unit, a learning center/language laboratory for individualized technical study and foreign language instruction, and a fully equipped communications department with offices, word processing unit, graphic and audio-visual production facilities, and distribution center for publications, scientific documents and training materials.

CIMMYT's Long-Range Plan for 1980-86 indicated the likely need for additional headquarters facilities for training and information activities. That need was further confirmed in 1982 by the CGIAR External Review of the Center's accomplishments and future program needs. The Board of Trustees, after a thorough review of the Center's training and information programs, has made a commitment to build the facilities described in this prospectus. Thus CIMMYT is seeking the required funds from its traditional donors as well as others interested in helping to assure expanding food supplies in the developing world.

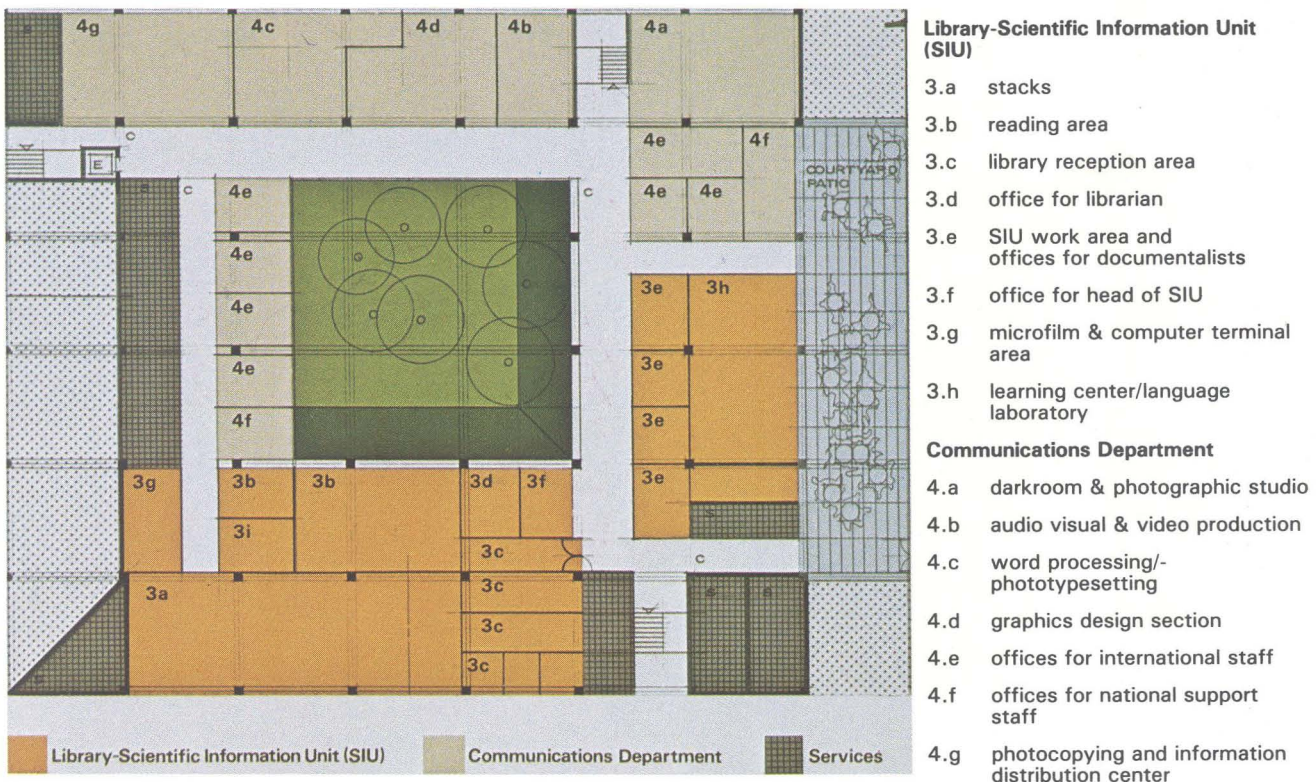

Basement Floor Level

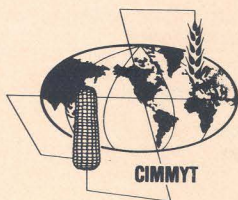

Centro Internacional de Mejoramiento de Maíz y Trigo
International Maize and Wheat Improvement Center
Londres 40, Apdo. Postal 6-641, México 06600, D. F., México